

Motor Vehicle Use Maps

The Motor Vehicle Use Maps (MVUM) display the Chequamegon-Nicolet National Forest's designated network of roads and trails for public motor vehicle use. The MVUM is your tool for knowing where you can legally operate your motor vehicle.

Access Maps on the Go

The Chequamegon-Nicolet National Forest's Motor Vehicle Use Map (MVUM) are available for **FREE** on your smartphone or tablet through the Avenza app. Just like the black and white MVUM, the electronic maps identify the roads, trails, and areas designated for public motor vehicle use on National Forest lands. Best of all, it lets you know exactly where you are while traveling on the National Forest. Learn more about the Avenza PDF Maps Application and install the electronic Motor Vehicle Use Maps on your smartphone or tablet at <https://go.usa.gov/xNMFA>.

To learn more go to <https://go.usa.gov/xNMFA> or scan the QR Code.



Chequamegon-Nicolet National Forest

Office hours: 7:30 a.m.—4 p.m.
Monday through Friday

Headquarters
500 Hanson Lake Road
Rhineland, WI 54501
715-362-1300

www.fs.usda.gov/cnnf

Facebook: <https://www.facebook.com/CNNF002>

Twitter: <http://twitter.com/CNNF002>

**Eagle River-Florence
Ranger District**
1247 E. Wall Street
Eagle River, WI
715-479-2827

5638 Forestry Drive
Florence, WI 54121
715-528-4464

**Medford-Park Falls
Ranger District**
850 N. 8th, Hwy 13
Medford, WI 54451
715-748-4875

1170 4th Ave.
Park Falls, WI 54552
715-762-2461

**Lakewood-Laona
Ranger District**
15085 State Road 32
Lakewood, WI 54138
715-276-6333

4978 Hwy 8 W
Laona, WI
715-674-4481

**Great Divide Ranger
District**
P.O. Box 126
N22223 Hwy 13
Glidden, WI 54527
715-264-2511
P.O. Box 896
10650 Nyman Ave.
Hayward, WI 54843-0896
715-634-4821

Washburn Ranger District
P.O. Box 578
113 East Bayfield Street
Washburn, WI 54891
715-373-2667

Addendum to the 2018
Motor Vehicle Use Map
serving as the ...

2019 Motor Vehicle Use Map

Chequamegon-Nicolet National Forest

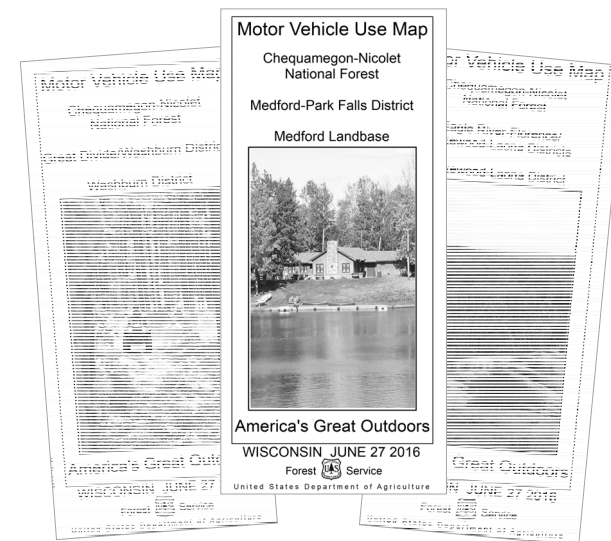

Forest
Service

Publication
05/19

Chequamegon-Nicolet National Forest

The Chequamegon-Nicolet National Forest had only minor changes to the Motor Vehicle Use Map (MVUM), therefore an addendum to the 2018 map has been provided outlining the changes; this addendum in conjunction with the 2016 map will serve as the 2017 MVUM on the Chequamegon-Nicolet National Forest.

In addition, the items identified in the addendum have been updated on the electronic MVUMs that can be downloaded from the Avenza App or accessed on the Forest website at www.fs.usda.gov/cnmf.

Map Removals:

Forest Road 2457H, Forest Road 2457HA and Forest Road 2864A on the Eagle River-Florence Ranger District are no longer roads open to the public on the 2019 Chequamegon-Nicolet MVUM.

Map Additions:

Forest Road 2909 on the Eagle River-Florence Ranger District has been added to the MVUM.

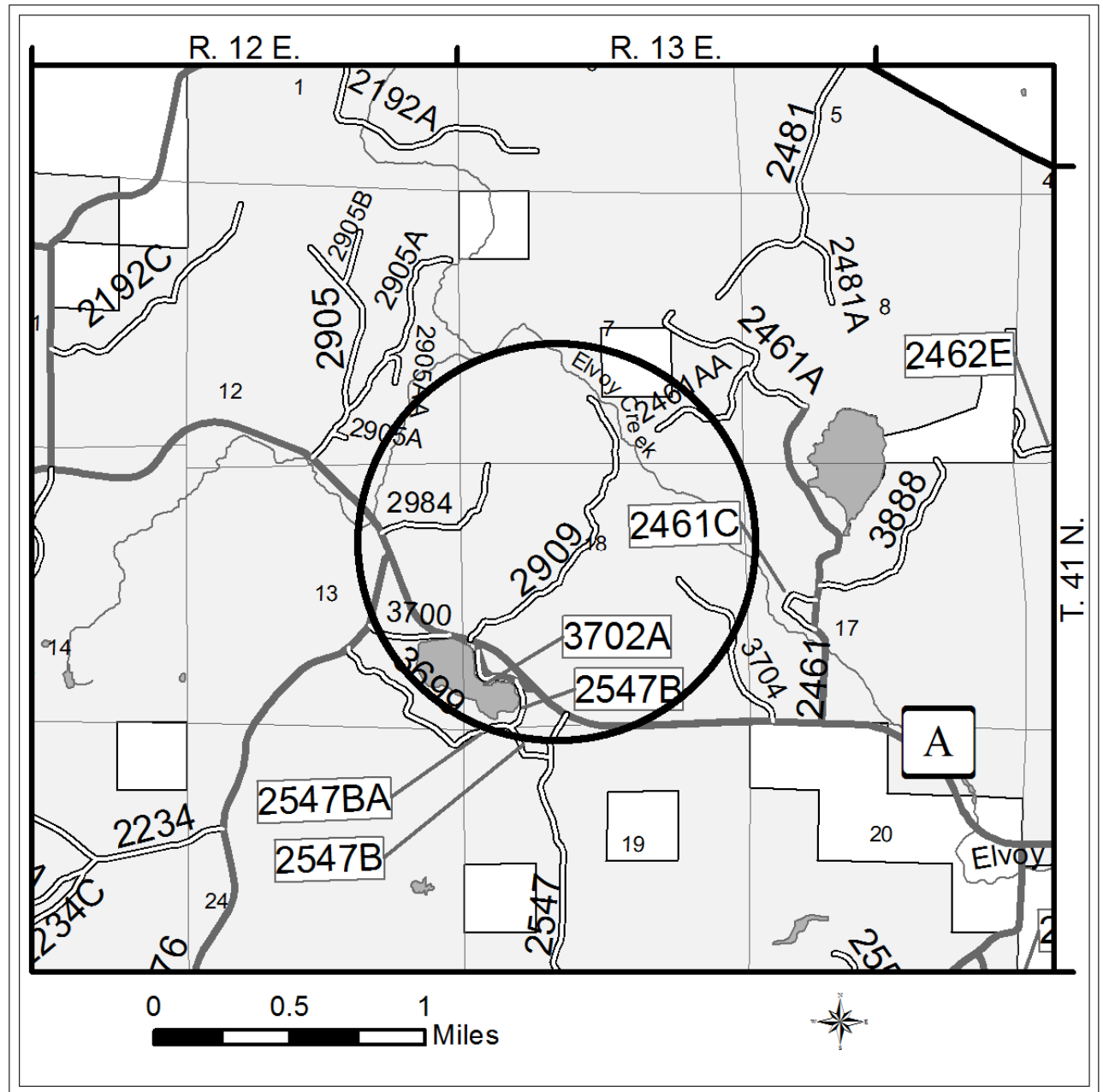

MVUM additions Forest Road 2909 on the Eagle River-Florence Ranger District.