

SUMMARY OF FALL 2003 WALLEYE RECRUITMENT SURVEY

LAKE: CHICAGON L	COUNTY: IRON
DATE OF SURVEY: 09/16/03	OBJECTIVE: ASSESS YEAR CLASS STRENGTH OF AGE 0 AND AGE 1 WALLEYE.
SAMPLING METHOD: BOOM SHOCKING	

SAMPLING INFORMATION

TOTAL SHOCKING TIME (HRS): 3.4	MILES SURVEYED: 10.4
WATER TEMPERATURE (F): 65	SHORE MILES: 10.4
VOLTS: 354 AMPS: 4	BOOM SHOCKER TYPE(S): GLIFWC DC
PULSES/ SECOND: 120 WIDTH: 3	
NUMBER OF CREWS: 1	WATER CLARITY (FEET): 4
	RELIABILITY: HIGH

CATCH DATA

TARGET SPECIES: WALLEYE

SPECIES	NUMBER CAUGHT	MIN. LENGTH	MAX. LENGTH	MEAN LENGTH	CATCH/EFFORT
WALLEYE: TOTAL	44	4.8	15.3	10.4	4.2 / MILE
WALLEYE: AGE 0	5	4.8	6.4	5.5	0.5 / MILE
WALLEYE: AGE 1	12	7.9	10.3	9.3	1.2 / MILE
SMALLMOUTH BASS	13	5.8	11.3	7.8	1.3 / MILE
YELLOW PERCH	16	4.3	9.3	6.7	
BLACK CRAPPIE	2	6.3	8.3	7.3	

COMMENTS

Water appeared to be low and green in areas. Lots of overhanging trees.
Numerous docks on the east side of the lake.

SMALL WALLEYE LENGTH-FREQUENCY FORM - CREW 1

CREW NAMES: SOULIER, KOLODZIEJSKI, BIGBOY

COUNTY: IRON	LAKE: CHICAGON L	DATE: 09/16/03	SHOCKING TIME (SEC): 12242	VOLTS: 354	AMPS: 4	PPS: 120	PW: 3
-----------------	---------------------	-------------------	-------------------------------	------------	---------	----------	-------

SIZE IN INCHES	NUMBER OF WALLEYE	SIZE IN INCHES	NUMBER OF WALLEYE
<2.0		7.0	
2.0		7.1	
2.1		7.2	
2.2		7.3	
2.3		7.4	
2.4		7.5	
2.5		7.6	
2.6		7.7	
2.7		7.8	
2.8		7.9	1
2.9		8.0	
3.0		8.1	
3.1		8.2	
3.2		8.3	
3.3		8.4	
3.4		8.5	1
3.5		8.6	
3.6		8.7	
3.7		8.8	1
3.8		8.9	1
3.9		9.0	
4.0		9.1	
4.1		9.2	2
4.2		9.3	1
4.3		9.4	
4.4		9.5	
4.5		9.6	
4.6		9.7	1
4.7		9.8	
4.8	1	9.9	1
4.9		10.0	1
5.0	1	10.1	
5.1	1	10.2	
5.2		10.3	2
5.3		10.4	
5.4		10.5	2
5.5		10.6	1
5.6		10.7	
5.7		10.8	2
5.8		10.9	2
5.9		11.0	
6.0	1	11.1	1
6.1		11.2	2
6.2		11.3	2
6.3		11.4	1
6.4	1	11.5	1
6.5		11.6	1
6.6		11.7	1
6.7		11.8	1
6.8		11.9	
6.9			
TOTAL:	5	TOTAL:	29

LARGE WALLEYE, GAMEFISH, AND PANFISH FORM - CREW 1
 CREW NAMES: SOULIER, KOLODZIEJSKI, BIGBOY

COUNTY: IRON	LAKE: CHICAGON L	DATE: 09/16/03	SHOCKING TIME (SEC): 12242
-----------------	---------------------	-------------------	-------------------------------

SIZE IN INCHES	SPECIES											SIZE IN INCHES	SPECIES			
	WALLEYE	MUE	NOP	LMB	SMB	YEP	BCR	BLG	PKS	RKB	*		WAE	MUE	NOP	
<3.0													27.0-27.4			
3.0-3.4													27.5-27.9			
3.5-3.9													28.0-28.4			
4.0-4.4						3							28.5-28.9			
4.5-4.9						2							29.0-29.4			
5.0-5.4													29.5-29.9			
5.5-5.9					2								30.0-30.4			
6.0-6.4					1	2	1						30.5-30.9			
6.5-6.9					1	1							31.0-31.4			
7.0-7.4					1	2							31.5-31.9			
7.5-7.9					4	1							32.0-32.4			
8.0-8.4					1	2	1						32.5-32.9			
8.5-8.9						2							33.0-33.4			
9.0-9.4					1	1							33.5-33.9			
9.5-9.9					1								34.0-34.4			
10.0-10.4													34.5-34.9			
10.5-10.9													35.0-35.4			
11.0-11.4					1								35.5-35.9			
11.5-11.9													36.0-36.4			
12.0-12.4	6												36.5-36.9			
12.5-12.9	2												37.0-37.4			
13.0-13.4	1												37.5-37.9			
13.5-13.9													38.0-38.4			
14.0-14.4													38.5-38.9			
14.5-14.9													39.0-39.4			
15.0-15.4	1												39.5-39.9			
15.5-15.9													40.0-40.9			
16.0-16.4													41.0-41.9			
16.5-16.9													42.0-42.9			
17.0-17.4													43.0-43.9			
17.5-17.9													44.0-44.9			
18.0-18.4													45.0-45.9			
18.5-18.9													46.0-46.9			
19.0-19.4													47.0-47.9			
19.5-19.9													48.0-48.9			
20.0-20.4													49.0-49.9			
20.5-20.9													50.0-50.9			
21.0-21.4													51.0-51.9			
21.5-21.9													52.0-52.9			
22.0-22.4													53.0-53.9			
22.5-22.9													54.0-54.9			
23.0-23.4													55.0-55.9			
23.5-23.9													56.0-56.9			
24.0-24.4													57.0-57.9			
24.5-24.9													58.0-58.9			
25.0-25.4													59.0-59.9			
25.5-25.9													60.0+			
26.0-26.4																
26.5-26.9																
TOTAL:	10	0	0	0	13	16	2	0	0	0	0	TOTAL:	0	0	0	

Chicagon Lake
Iron County
Date Surveyed: 09/16/03
Area: 1,100 acres
Shoreline: 10.4 miles
Surveyed: 10.4 miles

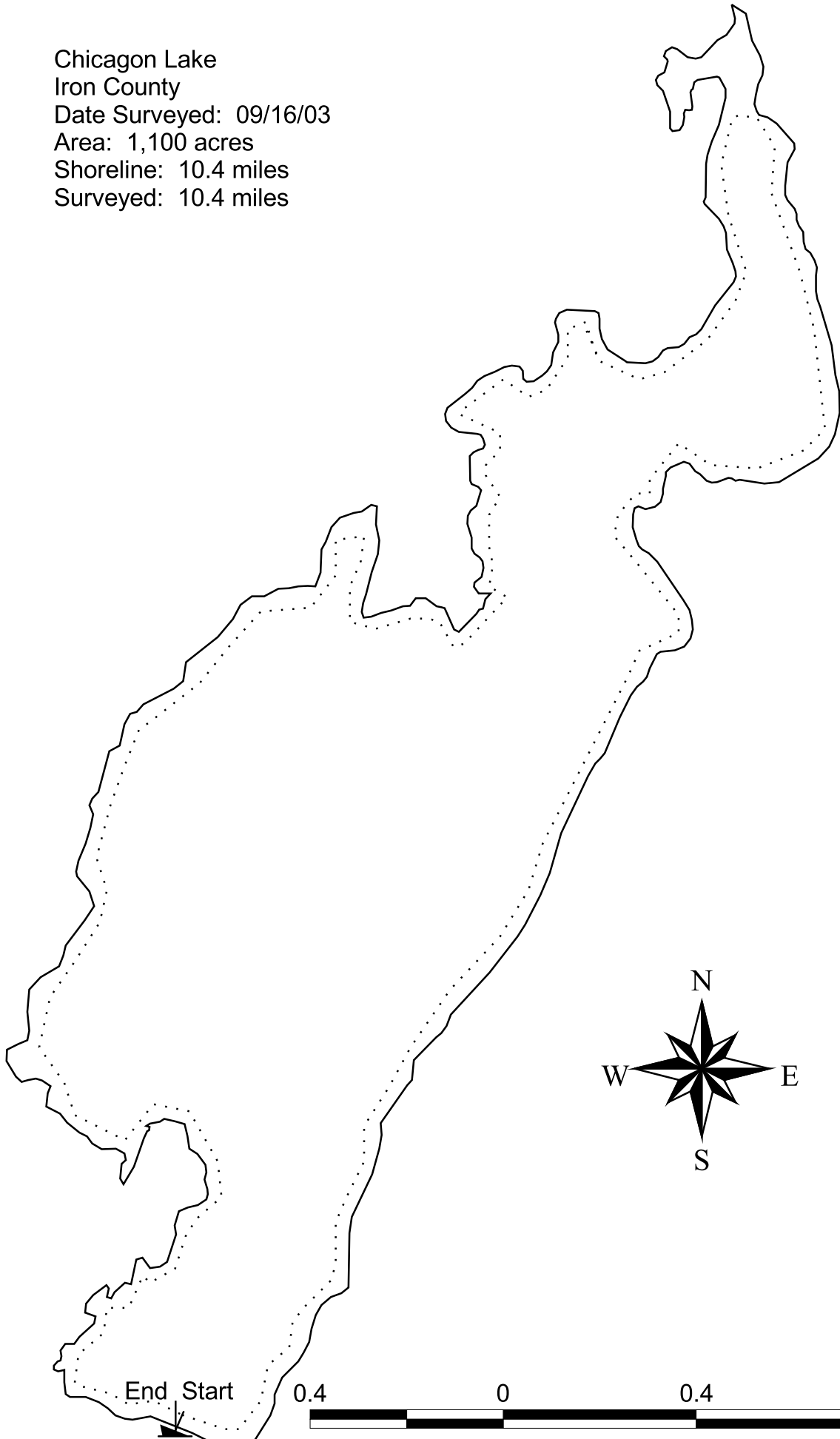

End Start
Boat Landing
0.4 0 0.4 0.8 Miles